

# HOUSE of the MONTH

# New Bern

November 2011

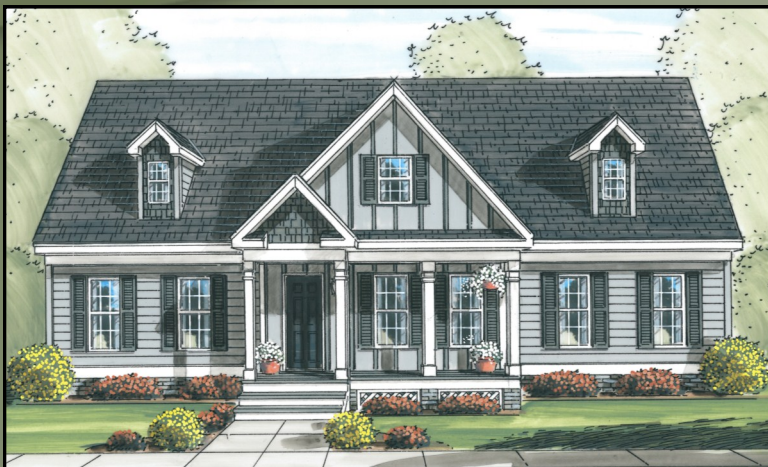

The artist's rendering shown includes optional and suggested features.

## EXTERIOR "PACKAGED FEATURES"

- Porch/Foyer Pod Standard On This Plan
- 12/12 Roof with 12/12 Double Gable Porch Roof
- Two 4' Dormers
- Shingle Eave Returns On Porch Roof (As Shown)
- 7 Pairs of Louvered Shutters on Front
- 6-Over-6 Window Grids Throughout
- Vinyl Shake Siding at Front Cape Dormers and Small Porch Gable
- Vinyl Board & Batten Siding at Front Porch & Large Gable
- 5/4 Pressure Treated Porch Decking
- Five White 4"x4" Wrapped Porch Posts

## New Bern

1735 sq. ft. Living Space

1042 sq. ft. Proposed Upper Level

102 sq. ft. Front Porch

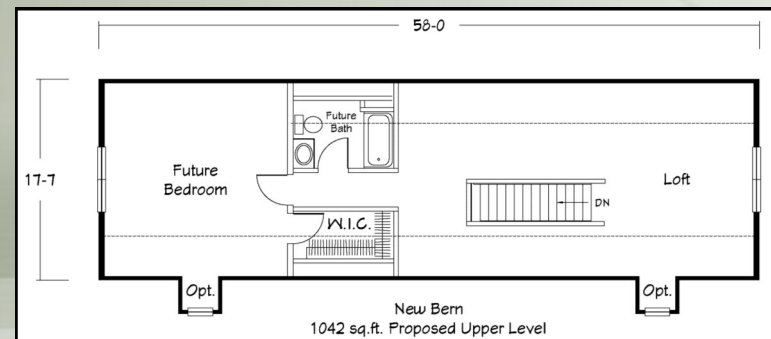

## INTERIOR "PACKAGED FEATURES"

- 9' Ceilings Throughout (8'6" Where Applicable)
- Two Drywall Columns with Crown & Bead Molding
- Angled Niche in Master Bath with Laminate Top, Recessed Light & Receptacle
- Sheridan 7-Piece Shaker Maple Cabinetry Throughout by Legacy Crafted Cabinets
- 42"/36" Staggered Overhead Cabinets in Kitchen
- Custom Island with Bookshelves Facing Living Room & Corbel Under Bar
- Decorative End Panels in Kitchen
- Extended Refrigerator Cabinet with Wine Rack
- Entertainment Center (EC-30B) in Living Room
- Utility Cabinetry (As Shown on Plan)
- Bookshelf Cabinet Over Tub in Master Bath
- Two Pendant Lights Over Island, One Over Kitchen Sink
- 12"x12" Snapstone Ceramic Floor in Master Bath
- Nafco Vinyl Flooring in Kitchen, Dining Room, Main Bath, Utility
- Laminate Plank Flooring in Foyer
- Std. Carpet in Living Room and all Bedrooms
- Plant Ledge in Master Bathroom (Only with 9' Ceilings)



Built to Classic  
Series Specs

